

PARISH NEWSLETTER

Issue No 51

www.saughall.gov.uk

February 2012

The Queen's Diamond Jubilee



The Official Emblem

In a nationwide competition run by the BBC children's programme Blue Peter, 10 year old Katherine Dewar from Chester, was chosen from 35,000 entries as the winning design of the Queen's official 2012 Diamond Jubilee emblem.

Katherine's design – which has a crown poised above the Union Jack alongside columns of diamonds – will be used by The Royal Household and others, as the official emblem for the Diamond Jubilee celebrations.

A child has never designed an official Jubilee emblem before. Previous emblems, which marked the Queen's Silver Jubilee in 1977 and the Golden Jubilee in 2002 were created by professionals – congratulations Katherine.

Competition - Projects to Celebrate the Diamond Jubilee

The Council is inviting all the various clubs and groups in Saughall to make proposals on how it would spend up to a maximum of

£500 on a project, which must benefit the local community, to celebrate the Queen's Diamond Jubilee. A Panel will be established to judge the entries. The winners will receive a grant to bring their proposals to fruition. Please send the details of your proposals to the Clerk by **31 March 2012.**

A Social Evening will be arranged where the funding will be distributed to the successful applicants.

Community Village Event - Music in the Park

Arrangements are being put in place to hold this event on Monday, 4 June 2012 between 4 and 10pm. There will be a Barbecue and a Beer Tent.

Bands interested in performing are asked to contact Jenny Young on Tel No. 881133 or email: chairman@saughall.gov.uk



Annual Parish Meeting

Parishioners are invited to attend the Annual Parish Meeting for the Parishes of Saughall and Shotwick Park, which will be held at **7:30pm Monday, 30 April 2012** in the **Vernon Institute.**

The Chairman will present a report on the work and activities of the Council during 2011/12. **This is your meeting** providing you with the opportunity to speak out on any matters that are causing you concern and on issues you would like the Parish Council to address.



Council Tax 2012/13

The Parish Council has set its budget for the next Financial Year and increased the precept, which means that the Council Tax will be £54.98 per household per Band D property as opposed to £44.53 in 2011/12. The Council has used its balances during the last two years to keep the precept as low as possible. Consequently, balances are now down to only £3,000 or so. This means that next year, despite making some savings, primarily in respect of litter picking, your Council Tax will increase.

The Council has asked Cheshire West and Chester Council for a Parish Precept of £63,278 for 2012/13. The Parish Council's budget amounts to £66,296.

Unlike Principal Authorities, Parish Councils do not receive Government grants and are wholly funded by Council Tax.

How your £66,296 is to be spent is set out in the Council's budget below.

Council Budget 2012/13

Budget Head	Allocation
Environment	16,366
Administration	19,260
Annual Payments	9,870
Community Facilities Fund	1,000
Police	11,800
Neighbourhood Management Team	1,000
Uniform Groups' HQ Rental	500
Community Action Projects	2,000
War Memorial Fund/New Roll of Honour	1,500
Contingency	3,000
Total	66,296

This budget can be viewed in more detail online at:

<http://www.saughall.gov.uk/Minutes/Budget/budget 12-13.pdf>

How your money is spent

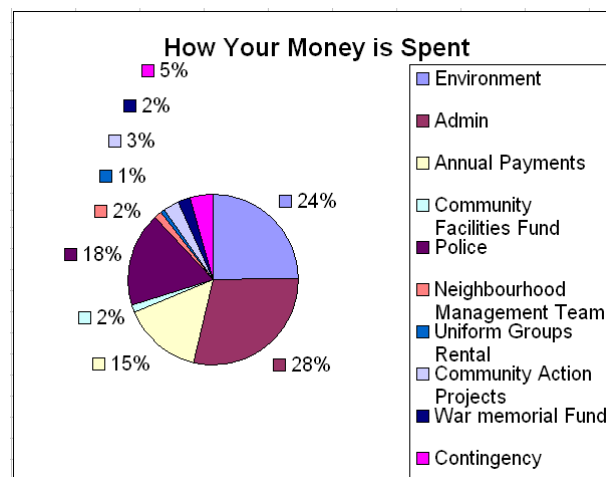

Elimination of Double Taxation

Background

The issue of double taxation has been repeatedly raised by parish councils across the Borough since the creation of the new Cheshire West and Chester Council (CWaC) in 2009. Following a scrutiny review of the Council's relationship with its parishes, its Executive agreed to explore the adoption of Special Expenses as a potential solution.

What is Double Taxation?

Double taxation relates to the provision of local services and the way in which those services are funded and subsequently charged to the taxpayer. It exists in areas where a parish council is delivering a function or service and charging local taxpayers for this through the parish precept, whilst elsewhere the service is being delivered by the principal council and funded through its element of the council tax. Where this happens, local taxpayers in the parish experience 'double taxation' as they are effectively paying twice for the delivery of the local service – once through their parish precept and again through the principal authority's element of the council tax. Government guidance recommends that principal councils take steps to alleviate or eliminate the impact of double taxation. One suggested approach is the determination and application of 'Special Expenses' to such concurrent functions.

What is a Special Expense?

A Special Expense is an expense incurred by a billing authority in performing, in a part of its area, a function performed elsewhere in its area by a parish council. The adoption of Special Expenses is provided for under the Local Government Finance Act 1992. It allows for different amounts of council tax to be calculated for different parts of an area depending on what, if any, special items relate to those parts. The detailed identification of concurrent functions is therefore essential for using this Special Expenses provision.

Why this option?

In exploring options to eliminate double taxation, a key factor was to ensure that the identified solution could be introduced within existing budgets and would have no impact on the overall level of income raised through council tax across the Borough. Treating expenses as Special Expenses does not affect the overall amount that the billing authority needs to raise through council tax and does not, therefore, affect the average amount of council tax across the whole of the area. It simply means that the council tax is:

- relatively lower for areas where the parish council performs the concurrent function, as it includes the parish's costs but not the council's costs of performing that function elsewhere; and
- relatively higher, for areas where the council performs the concurrent function, as all of the council's costs of performing the concurrent function are met by taxpayers in the areas where the council performs it.

Which functions have been identified as 'concurrent'?

Three potential concurrent functions have been identified at this stage based on available delivery and costing information – open access play spaces, Christmas lights and Police Community Support Officers (PCSOs). These are all functions performed by CWaC in some parts of the Borough and parish councils in others.

How have the Special Expenses been calculated?

For open access play spaces, the average cost calculated per site is £6,682 per annum. This covers all costs relating to repair, inspections, insurance and routine site maintenance, such as grass cutting and bin emptying. For Christmas lights, the actual costs of provision have been identified and include testing, repair, installation/removal and energy consumption. For PCSOs, the actual individual charge per officer (£11,800) has been used.

How have they been applied?

In setting the council tax for Special Expenses, CWaC must ensure the tax is levied only on the areas to which those expenses refer. As such, the total expenditure incurred by CWaC for each of the three concurrent functions has been deducted from its base budget and then reapplied only to those areas where the Council is performing the function.

What does this mean to the taxpayers?

The position will vary across the Borough, with taxpayers either seeing a reduction on their council tax or an increase depending on what, if any, Special Expenses are applied. Generally, those living in the unparished areas of Chester and Ellesmere Port (covered by the Charter Trust) or those living in small parished areas where CWaC is funding open access play spaces or Christmas lights will see an increase.

What happens next?

The Leader of CWaC has written to all parish councils and known residents/community groups informing them of the proposals and seeking their views on implementation. The results of this consultation will be considered at the meeting of its Executive on 8 February 2012, prior to any subsequent recommendation on adoption being made to CWaC on 23 February.

Litter Picking

In an attempt to keep the Council tax as low as possible the Parish Council has made the decision to leave the village's litter picking arrangements entirely to Cheshire West and Chester Council from **1 April 2012**. It will no longer supplement the street cleansing the Principal Authority provides. Therefore, it has only made budgetary provision to keep the Golden Jubilee Park (which is in its ownership) clean and tidy.



However, the Council will continue to monitor the state of the village. Any litter problems will be reported to CWaC who will be expected to take appropriate action and deal with them. From 1 April 2012 please report your street cleaning issues by ringing Tel No. **0300 123 8 123** or in person at any of CWaC's One Stop Shops or by filling in its online form.

https://forms.cheshirewestandchester.gov.uk/showform.aspx?form=~sitecollection/formservertemplates/cw_streetclean_attach.xsn&redirect=www.cheshirewestandchester.gov.uk/default.aspx?page=12691



Keep Saughall Tidy

Don't drop litter, put it in one of the many litter bins dotted around the village or take it home. Also, do not over load your bins. Make sure that the lid goes right down and that rubbish can not escape.

Protection of the Local Green Belt

Steve Robinson, Chief Executive of Cheshire West and Chester Council has confirmed that his Council's proposal for a transit Gypsy and Traveller and Show Person site at Oakwood Farm, Saughall has been dropped. The decision was taken on 2 November 2011 at a meeting of the Council's Executive. The link to see it is:

<http://cmttpublic.cheshirewestandchester.gov.uk/ieListDocuments.aspx?CId=443&MId=2813&Ver=4>



The decision is the subject of a call in which is still to be considered by the Council's Corporate Scrutiny Committee, having been deferred at its meeting on 16 January 2012.

Parishioners have raised concerns over the proposal to develop Green Belt land as a transit site for Gypsies and Travellers at our Parish Surgeries. The general view is that Green Belt land must be protected and they were pleased that the Principal Authority has been forced to drop its proposal because of the discovery of several protected species of bat living on the site.

The Parish Council is adamant that it will never ever agree to any inappropriate development in the Green Belt!

Chester Half Marathon, Sunday, 13 May 2012



Cheshire Oaks Chester Half Marathon is supporting Northern Lights who give seriously ill children the unique experience of a very special holiday to meet Santa in Lapland. Every December they take 10 or more children, aged between 6 and 11, on a 5-day all inclusive holiday to a luxury resort above the Arctic Circle in Lapland.

Each year an amount from the race entry fees is donated to the official race charity.

Runners will also be invited to raise money and it is hoped that in excess of £10,000 can be raised for Northern Lights.



Northern Lights celebrate their 25th year in 2012 and are looking forward to doing this by raising £25,000 to take twice as many children on holiday.

Saughall is on the Marathon route this year! This means that Lodge Lane, Church Road and Hermitage Road will be closed and the bus route will be closed off for three hours.

The Marathon will start at the Race Course at 9:00am and it is expected to be finished by 1:00pm.

When Does the Council Meet?



The Council is scheduled to meet next at **7:30pm: on Monday, 5 March 2012 in the Vernon Institute on Church Road.**

Notices for all Council and Committee meetings are posted on the Council's notice boards and website. Agendas for meetings are always on deposit in the Co-op Store and posted on the Council's website (www.saughall.gov.uk).

Any resident on the Electoral Roll of Saughall or Shotwick Park is more than welcome to attend all of these meetings.

The Localism Act 2011

November 2011 saw the Localism Bill receive Royal Assent and become the Localism Act. It is a testament to how much is riding on this new Act that it made it

through Parliament before Christmas and has come through relatively unscathed.

As you might expect Localism, and in particular Neighbourhood Planning, is now dominating the agenda and there is a growing realisation that to make it work in every parish and community across the country there is a need for a reinvigorated, fit-for-purpose parish council sector supporting communities and acting as the spider at the centre of the Big Society web.

“What does the Localism Act mean for Parish Councils in Cheshire?”

The only true answer is that no one knows – because the Localism Act only sets out a direction of travel, it is not a detailed travel plan. It's like saying “we're going to France”, without saying when you're leaving, how you're going to travel, which bit you're going to and for how long you're going. Without that rather important detail it is a bit difficult to say what the impact of the journey will be. In the case of the Localism Act the detail will be provided in secondary legislation and regulation by the Secretary of State for Communities and Local Government that will flow on from the Act over the course of the next six months to a year.

However, the question as to what it means for parish councils remains. The three areas of most relevance to parish councils seem to be: the General Power of Competence, Neighbourhood Planning and Ethical Standards.

The General Power of Competence (GPoC)

The Act provides that “*A local authority has power to do anything that individuals generally may do.*” This is a really big and important change for parish councils, which previously only had the power to do things that were specifically prescribed in law. Parish councils were at risk of being caught *ultra vires* if there was no specific statutory power underpinning their activities. The “catch all” provision of section 137 of the

1972 Local Government Act was limited in its scope being capped at around £6 per elector and with various other peculiar restrictions on its use. The lack of a statutory power has sometimes been a source of frustration to parish councils when a perfectly reasonable action had been proposed but was subsequently deemed *ultra vires*. A common example is the purchase of a commemorative gift for a retiring councillor of long standing – there is no specific power for this and it does not comply with one of the requirements of s137, which is that the expenditure cannot benefit an individual. Many other examples exist where the law is so unclear that councils have eventually chosen not to act in order to stay on the safe side.

GPoC is intended to release parish Councils from the legislative straightjacket in the hopes that the sector will become more ambitious, more aspirational and more innovative. So, section 1 confers the power but (as opponents of the Act pointed out when it was at the Bill stage) sections 2 to 8 set about defining the limits of its operation. Why have a general power if it is then heavily caveated with significant powers for the Secretary of State to wind the rope back in if ever required?! Of particular consequence to parish councils is section 8(2) of the Act, which states that “*A parish council is “eligible” for the purposes of this Chapter if the council meets the conditions prescribed by the Secretary of State by order for the purposes of this section.*” In other words, entitlement to use GPoC will be subject to eligibility and we are yet to hear what the criteria will be. There is speculation that there will be an elected mandate requirement (e.g. 66% of councillors elected at the last ordinary election) and possibly a training requirement. It is predicted that the eligibility criteria will be easily attainable and well within the reach of the vast majority of parish councils. Nevertheless, hoops there will be.

In the future lack of legal power is less likely to be the limiting factor, but all that means is that new projects will depend on the next limiting factor... culture, funding, capacity,

training, knowledge, aspiration, commitment, risk aversion etc. Undoubtedly there are some parish councils that are at the bleeding edge of project and service delivery innovation, but the whole culture of parish councils has been created under a blanket of restrictive powers and tight frameworks of governance and accountability. Like prisoners released from solitary confinement parish councils will stumble blinking in to the light, but it may take them many years to adjust to their new-found freedom and to build up their confidence to take on more. It is at this point that it is appropriate to point out that GPoC is a discretionary power... it's there for those councils that want it and need it.

Neighbourhood Planning

Be careful what you wish for, it may come true! Parish councils have for years sought to have more influence in the planning system. Incredible frustration results when the parish council makes what it sees as perfectly justified observations on a planning application only for a planning officer, or worse still, the councillors on the Local Planning Authority's Planning Board, to “ignore” the comments and make a contrary determination. In many cases it's not that the comments were ignored, it is just that they were not based on material planning considerations, or that there were other comments/policies/objectives that had to be taken in to account also.

Neighbourhood Plans, developed by communities themselves, will be part of the statutory Local Plan and will have to be taken in to account by the Local Planning Authority (LPA) when determining applications in that area.

So what are they and how will they work? Well, because it's the Localism Act we only know the headlines not the detail.

Neighbourhood Plans and Neighbourhood Development Orders will relate to a Neighbourhood Area. The Neighbourhood Area can be all or part of a parish or even comprise of more than one parish. In

unparished areas the relevant Local Planning Authority (LPA) will have the power to authorise an organisation or body to act for that Neighbourhood Area and the organisation or body will be known as the Neighbourhood Forum (comprising a minimum of 21 people coming together for the purposes of promoting or improving the social, economic or environmental well-being of an area).

For parished areas it is assumed that in most cases the Neighbourhood Area will be contiguous with the civil parish, but the flexibility in the Act allows for very large parishes to be divided in to more than one Neighbourhood Area and for very small parishes, including those served by Parish Meetings, to club together to form a single Neighbourhood Area between them.

Schedule 9, Part 2, section 7 of the Act provides that "A "neighbourhood development plan" is a plan which "sets out policies (however expressed) in relation to the development and use of land in the whole or any part of a particular neighbourhood area specified in the plan." Neighbourhood Plans are being described as "beefed up Village Design Statements (VDS)" and perhaps that's a good description. Neighbourhood Plans are being seen as more like a VDS than Parish Plans, which by design include all sorts of things that are nothing to do with planning and development control. However, we don't know enough about them yet, except that putting one together is expected to cost in excess of £17,000. In the meantime, the Council intends to proceed with refreshing its Parish Plan which is considerably out of date having being drawn up following a village consultation exercise carried out in 2003.

Neighbourhood Plans will be mainly about spatial planning, i.e. where in the Neighbourhood Area to put housing, employment, industry, recreation facilities and green open space. Neighbourhood Plans will require an evidence base to be established of the area's needs and aspirations and they are intended to be a

positive statement for growth, rather than a collection of reasons for no growth. How relevant and cost effective such a document will be for small rural parishes is open to debate.

Ethical Standards

The Councillors' Code of Conduct is dead; long live the Code of Conduct. Yes, Schedule 4 of the Localism Act abolishes Standards for England, the Quango that was responsible for overseeing the operation of the Code of Conduct of Local Authority Members in England. Many thought that the whole Standards regime, including the Code of Conduct, would disappear along with the Quango, but this turned out to be not quite the case. Part 1, Chapter 7, paragraph 27 of the Act imposes a new duty to "(1) *promote and maintain high standards of conduct by members and co-opted members of the authority, and (2) In discharging its duty under subsection (1), a relevant authority must, in particular, adopt a code dealing with the conduct that is expected of members and co-opted members of the authority when they are acting in that capacity.*" So parish councils will still need to have a Code of Conduct.

Parish Councils can adopt their own Code but it must comply with the requirements of the Act. Alternatively, parish councils can use the Code that is adopted by the borough council for their area and in so doing are deemed to have complied with the requirements of the Act. Any Code must be consistent with the principles of selflessness, integrity, objectivity, accountability, openness, honesty and leadership (The Nolan Principles). Most parish councils will simply adopt the same Code as is used by their borough council.

The actual system for dealing with complaints will not be much different. Complaints or allegations of breaches of the Code will be made to the borough council, just as now. The only difference is that the borough council can no longer escalate serious complaints to Standards for

England. The Monitoring Officer at the borough council will continue to be the person responsible for the application and observation of the Code by parish councillors.

One key change is the creation under Part 1, Chapter 7, section 34 of the Act of a criminal offence for failure to declare a “*disclosable pecuniary interest*”. Prosecution could lead to a fine of up to £5,000 and disqualification from being a councillor. The new Standards regime will have considerably more teeth than the old system and only time will tell (a) how the system operates and (b) how frequently breaches result in prosecution.

Parish councillors will still be required to maintain a Register of Member’s Interests and they will be published on the borough council’s website and the parish council’s own website.



Business Plan

The Council’s Business Plan is on the Parish Council’s website. You can access it by clicking on the link below.

<http://www.saughall.gov.uk/Minutes/Saughall%20and%20Shotwick%20Park%20Parish%20Council's%20Business%20Plan.pdf>

This Business Plan is a “living document” and is regularly reviewed and refreshed. It maps out the Parish Council’s hopes and aspirations for the future and will help the Council to take a planned and consistent approach to:

- the design and delivery of the services it provides;
- prioritising and allocating its resources; and
- achieving real value for money.

The Council is now drawing up an action plan for the period of time the Business Plan covers.

Parish Plan Review and Refresh

The Council is about to start work on the production of a new Parish Plan. Therefore, it is important that you begin to think about what type of village you want to live in, in the future, looking twenty years or so ahead. This is in line with the concept of “localism”.



Please help revitalise your village by feeding your initial views into the parish plan process via the Clerk or any Parish Councillor. There will be a full public consultation exercise carried out in respect of this later in the year.

This is an opportunity for us all to take stock of our village; to identify what is needed to revitalise it; to have a voice on our own future; to provide support to the Plan; and to implement some of the improvements required locally.



This is a campaign aiming to bring Superfast Broadband and improved broadband speeds to communities and businesses across Cheshire and Warrington. It is a joint project between Cheshire East Council, Cheshire West and Chester Council, Warrington Borough Council and Halton Borough Council.

The campaign argues that in large towns and cities Superfast Broadband is being installed at a fast rate leaving many parts of Cheshire, Warrington and Halton, particularly the rural areas, with their current slower internet speed. It is a large challenge to bring faster internet speeds to smaller towns and rural areas and this is why the four councils are working together with the community, internet providers and suppliers.

Cheshire, Warrington and Halton need access to high speed broadband so they can continue to be good and competitive

places to live in and do business in. The benefits of Superfast Broadband could be seen quickly with the increase in the quality of our services, facilities and applications for both residents and business. However, it is the potential for development and new ideas that is most exciting about the Superfast Broadband technology.

What could you do with increased speeds and more advanced technology?

The campaign argues there are huge benefits to having Superfast Broadband for everybody, though the needs of different users will vary for each task. It highlights just a few of the many benefits for home users, which include quicker movie downloads, streaming high definition TV and films, plus many, many more.

There are numerous benefits of Superfast Broadband for business users too. These include faster file transfers, better reliability, more effective usage of VPNs and other remote technologies – among many others. The best thing to do is to register your interest in getting Superfast Broadband. The more evidence **Connected Cheshire** can show for a real demand in Cheshire, Warrington and Halton the quicker it can bring it to the area.

It is pointed out that people can also drum up support in their local community and there are ideas for getting whole communities interested in bringing Superfast Broadband to Cheshire, Warrington and Halton.

The Parish Council believes there may be significant benefits for organisations and businesses that operate in the parish and has included the promotion of Superfast Broadband in its Business Plan and is raising local awareness of its benefits through this Newsletter.

The **Connected Cheshire** partnership aims to deliver Superfast Broadband to every resident and business by 2015. It has secured over £3m to start the process and

needs local communities such as Saughall and Shotwick Park to help it demonstrate:

How much the community needs the technology?

What we will use it for?

What we can do to ensure everyone benefits?

Saughall and Shotwick Park's input will help the partnership attract the match funding needed to achieve its aim of providing superfast broadband access to every household.

To find out more contact Connected Cheshire at info@connectingcheshire.org.uk

Bowling Green



The Council wants to provide a bowling green facility in the Golden Jubilee Park. If you would like to help, by working as part of the team that will make this project happen, then inform any Parish Councillor or the Clerk that you would like to be one of the 'Project Champions'. Your help will be gratefully received.



Overhanging Trees and Hedges

The Parish Council would like to remind you to cut back trees and hedges that overhang and obstruct pavements, pathways and streetlights. There have been several complaints with regard to obstructions and it causes unnecessary annoyance to pedestrians, particularly anyone who is blind or has poor eyesight.

If these hedges and trees become very overgrown the Principal Authority may cut them back and then charge you for doing so.

Taxi licensing

Residents are being asked for their views on proposed taxi licensing changes to improve the service for passengers and drivers alike.



Cheshire West and Chester Council inherited different policies from the previous local authority areas of Chester, Ellesmere Port and Neston and Vale Royal. This means taxis, otherwise known as Hackney carriages, adhere to differing rules in each area for fares, licence restrictions and vehicle type and colour.

The Council is looking to standardise regulation so that passengers, drivers and operators throughout the borough benefit from clear and consistent standards. A three-month consultation period will end on Monday, 16 March 2012.

Copies of the questionnaire are available in public buildings and community venues throughout the borough, backed by a poster and press advertising campaign.

Message from PCSO Wendy Leason

I would like to take this opportunity to advise motorists that positive action will be taken with regard to parking and speeding offenses. Any vehicle parked in a manner that causes an obstruction will receive a £30 Fixed Penalty Notice.



Parking Issues remain a major concern at the end of the school day, causing congestion and obstructing bus services. Please be mindful of others and careful where you park your vehicle.

I would also like to encourage parents to walk their children to and from school when possible and refrain from parking in the Co-op Store's car park, unless you are actually

going into the shop, as a customer, to buy something.

To deter motorists from speeding in the village I have arranged some "Driver Engagement Days" which will involve a joint agency approach to educate motorists on speeding, using a mobile phone whilst driving and not wearing seatbelts. I will also be deploying the Smiley Speed Indicator Device (SID) and using the speed gun to encourage motorists to keep within the speed limits.

I know that Dog Fouling is a problem in the village. I have notified Cheshire West and Chester Council's wardens who will monitor the situation and will arrange an event in the area, possibly in February, to encourage people to pick up after their animals. I have also put advisory leaflets through doors in the vicinity of the village which is most affected.

Police Visibility

Police officers are deployed where demand is most needed. There are also more police officers deployed at weekends which are one of the busiest times. Officers need to quickly respond to accidents which is why they might not be seen patrolling on foot.



There are units that deal with incidents and issues in the rural areas. If these areas enjoy low levels of crime, there could be an impression that there are not any police officers as the Constabulary focus them where the crime is taking place. All rural areas are monitored and police response times are also monitored to ensure adequate coverage is provided.

Homewatch

The purpose of Homewatch is well known and self explanatory – to make communities safer. It is



a system of local awareness between residents and is one of many similar schemes operating nationally for dwellings, shops, schools etc.

It is co-ordinated by representative volunteers of the village for the benefit of the local population. Far from replacing or doing the work of the local police, it merely seeks to provide an informal lookout service that complements the work of the Police. Because Home Watch Co-ordinators cover a very localised area over which they 'watch', it means they are likely to be able to provide a more effective and reassuring 'point-of-contact' service as a result.

The Co-ordinator for Saughall Parish Council is its point of contact for receiving Homewatch messages from Cheshire Police on matters of mutual concern or more detailed interest. Information received from the Police and circulated for your attention is merely to keep you aware of any local advice.

If you would like to help with this initiative please contact Ian Humphrey.

The Homewatch provides a free property marking service for such things as flat TVs, laptops, photo screens, stereo systems, sky boxes etc. They can be marked with your post code and house number. Also, small homewatch labels can be affixed to all doors from the inside.

Please be ever vigilant and report anything you consider suspicious or inconsistent to Ian Humphrey.

Ian Humphrey
Homewatch Co-ordinator
Tel: 880011

Neighbourhood and Homewatch Week 2012

Neighbourhood and Homewatch Week will run from 16 - 24 June 2012 so please put those dates in your diary!

The focus for the Week will be around Homewatch's 30th anniversary and being the largest voluntary movement in the UK, with a particular emphasis on linking with police support volunteers and the Special Constabulary.



How to Contact Cheshire Police

Non-emergency calls 0845 4580000
Only use 999 if....

- There is danger to life
- Violence is used or threatened
- A serious crime is in progress or likely to occur
- A suspect is nearby
- There is a road traffic collision involving personal injury or danger to others
- A vulnerable person needs urgent assistance

Report Anti - Social Behaviour Now

If you are experiencing anti - social behaviour and you think that Cheshire West and Chester Council should help address it, or you would like a Community Safety Warden to contact you please ring **0300 123 7033**, Monday - Thursday 8:30am - 5:30pm, Friday, 8:30am - 5pm (excluding Public Holidays) or fill in the online reporting form at www.cheshirewestandchester.gov.uk



Cheshire West and Chester Council's Responsive Service Guarantee

Abandoned Vehicles – will be investigated by the end of the next working day.

Business Waste Compliance – will be investigated by the end of the next working day.

Racist or Abusive Graffiti – on relevant land will be removed or obliterated within 24 hours.

Fly Posting – will be investigated and removed from relevant land within 2 working

days.

Fly Tipping – will be investigated by the end of the next working day and cleared within 2 working days following completion of the investigation.

Nuisance Vehicles – will be investigated within 2 working days.

Dead Animals –will be removed from relevant land within 24 hours.

Sharps/Drug Related Litter – will be removed from relevant land within 4 hours.

Dog Fouling – will be removed from relevant land within 24 hours.

Overflowing Bins – will be emptied by the end of the next working day.

Damaged Street Furniture – will be investigated by the end of the next working day. The Tel. No. to ring is **0300 123 7026**

Parish Council Surgeries

Parish Council Surgeries will be held between 10.00am and 10.45am on the following Saturdays:

- 4 February
- 3 March
- 31 March
- 5 May



Notices will be posted on village notice boards, well in advance, to inform where Surgeries are to be held.

Planning Matters

If you are concerned about a planning application that affects you, please remember that Cheshire West and Chester Council does consult with the Parish Council, who is a statutory consultee, as part of its decision-making process. The Parish Council can send a representative to speak at Planning Board meetings.

In forming its views about planning matters, the Parish Council **ALWAYS** wants to know what villagers think, so please make sure you make your views known to us.

Wain Court Official Opening



The official opening of Wain Court was on 27 January 2012. This was an informal gathering with Parish Councillors, residents of Wain Court, Officers from Chester and District Housing Trust, Cheshire West and Chester Councillors, Residents' Panel members and representatives from the contractors, G & J Seddon.



2012 Rose Queen

The Rose Queen will be crowned on Saturday, 30 June 2012.



Lodge Lane - Affordable Housing Scheme



Planning consent has now been granted for 18 new affordable homes on land off Lodge Lane.

The project has developed through a dedicated partnership consisting of the Parish Council, Cheshire West and Chester Council and Chester and District Housing Trust.

An application will now be made to English Nature for a licence to exclude newts from the site. Ecological work is planned to commence in the spring with construction starting early summer 2012.

Holly Stiles
Development Officer
Chester and District Housing Trust

Former Ridings Infant School Site

Steve Robinson, Chief Executive of Cheshire West and Chester Council, has advised that a conditional contract has been agreed with Morris Homes, in which they are contractually obliged to submit a planning application for residential development by 2 March 2012. CWaC have reserved a right to terminate the contract if an application is not submitted within this timescale. However, there are various extensions of time permitted within the contract, which in essence allow Morris Homes to submit a planning appeal application and deal with any outstanding conditions stipulated by planning, if forthcoming.



Saughall Gardening Club

Saughall Gardening Club meets in the Vernon Institute on the third Monday of the month at 7:30pm. All are welcome and the annual membership is

£1. For more information please contact:

Gill Whittaker
Tel: 881059

Saughall Uniform Groups

Beavers – Mondays, 5– 6pm
Age: 6 – 8
Tel: 881348



Rainbows – Thursdays, 5:30 – 6:30pm
Age: 5 – 7
Tel: 372637

Brownies – Tuesdays, 6 – 7:15pm
Age: 7 – 10
Tel: 881284

Guides – Tuesdays, 7:30 – 9pm
Age: 10 - !!!
Tel: 881133

To hire the Scout Hut Tel: 881284 or 881133.

Can you spare some time to help with these Groups please? A CRB check is not required for occasional helpers.

Jenny Young
Tel: 881133

SJR Health and Fitness – Ladies Bootcamp

Every Saturday morning, a group of hardy ladies get together at the Scout Hut in the Golden Jubilee Park to participate in a Ladies Bootcamp. The Bootcamp has grown in popularity over the last 18 months and provides an opportunity to work out in the fresh air and with a group of like minded ladies.



During the Bootcamp, the participants get involved in boxing, sprinting, hoola hooping and dumbbell and kettlebell exercises. The sessions are run by a female personal trainer who lives in the village. Advice is available on how to best manage weight/diet/exercise to create an overall healthy lifestyle.

The aim of the Bootcamp is to increase fitness levels, tone up and help with weight loss whilst having fun in the fresh air. At the beginning of each Bootcamp, all participants are weighed and measured and then again at the end of the Bootcamp – the results so far have been fantastic.

Sessions are held on Monday morning, Wednesday evening and Saturday morning.

If you are interested in joining, contact Sue Richards at SJR Health and Fitness on 07789072109 or e-mail sjrfitness@yahoo.co.uk. Visit our facebook site – sjrfitness.

Vernon Institute (VI) – Development Proposals

In the last publication it was explained that a Development Committee had been set up to establish the best way to renovate some of the existing building at the back of the VI which currently houses a number of wooden sheds.



After a village consultation exercise, plans have been drawn up and include a new multi-functional room with a stage which can accommodate 120 people, a coffee shop which could become the 'Tea and Chat' Centre for the village and a Social Club. These proposed new facilities would dovetail with the existing large and small halls to bring a whole host of opportunities that the village doesn't currently cater for.

Local builders have been asked to quote for the work, meetings have taken place with the Planning officers, the various groups that currently use the VI have been consulted and their views are being built into the overall scheme of things. The plans have been converted into a model and the whole village was invited to a very successful evening at the VI in December 2011, to discuss the improvement proposals further before we finally submit a planning application in the next few weeks.

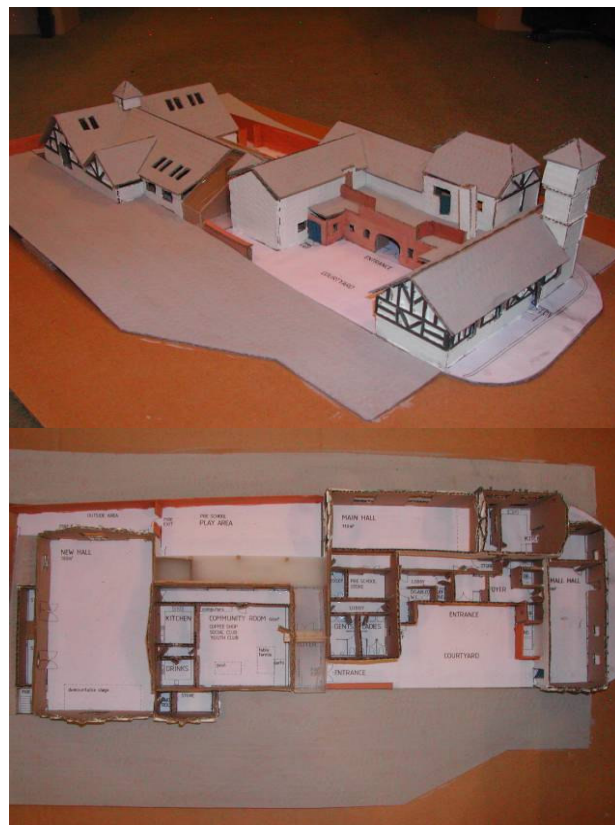

A number of grant making organisations have been approached for an indication of support and so far six of the nine that have been contacted are showing an interest. This is a long hard road but is all part of the five year plan to make the VI a focal point in the village with facilities that will draw in a wider audience.

Any comments from the village would be welcome by email to: andrew.errington3@virgin.net or by writing to the VI on Church Road.

Andrew Errington, Chairman Development Committee

Saughall's Christmas Celebrations at the Vernon Institute

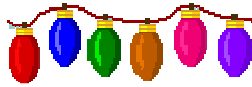

The VI Management Committee would like to thank everyone in the village who supported the Christmas Lights switch on and Celebrations.

We would like to thank all the children from All Saints Primary School who sang beautifully on the night and those that drew some lovely pictures for the VI drawing competition.

Special thanks to the Saughall Rotary for providing the float and the village collection that was donated to the VI.

We were very pleased that Tom and the staff at The Greyhound joined in the event with their own Christmas tree and lights and special thanks to Carl Whitney for donating the trees.

The Christmas celebrations continued with the Christmas Band Concert which was well attended and enjoyed by all.

We raised over £1,000 for the VI and I personally would like to thank all of the VI Management Committee members for their support with the events.

The Fund Raising Committee is looking for ideas for the coming months and a Spring Band Concert is being planned - more details next time.

Remember the VI is your Village Hall and with your support we hope to deliver improved facilities for all age groups.

Chris Harman, Chair
Vernon Institute Management Committee
Tel; 07966 759100
Email: chrisjharman@aol.com

News from All Saints Church



As you may have realised from the appearance of the scaffolding around the church, we have finally been able to start the re-tiling of the church roof that our architect has been telling us for ten years is necessary because of the deterioration of the existing tiles. We are very grateful to everyone who has contributed to the Roof Appeal over the last year or so, which has raised a significant proportion of the money needed. The remainder will come from the sale of the remaining part of Thomas Wedge School to Jason Ashcroft of Chestnut House, who is planning to use it to develop his children's day nursery business. The work on the church roof should be finished by Easter. Please contact the police immediately if you see any suspicious activity around the church, especially while the scaffolding is in place. The work includes adding insulation to the roof – so the church should be even warmer in future!

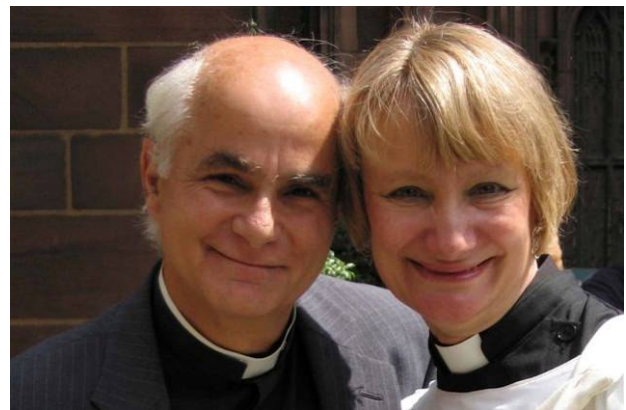

Some of you will have seen a removal van at the Vicarage at the beginning of January. Alison, my wife, has become Vicar of Witton in Northwich and I am now commuting from there on a daily basis. I will continue as the Vicar of Saughall for several months, but hope to get a parish near to Northwich some time later this year. Both Alison and I have been extremely happy in Saughall and I shall be very sad to leave when the time comes – but that is for the future! The process of finding someone to replace me will begin once we know when I will be

leaving. In the meantime, I can be contacted on the Vicarage phone 880213, or my mobile 07969 006085. Heather Pang, who has been curate at All Saints since last July, can be contacted on 07769 771765.

Our thanks go to everyone who has supported the church recently. We had a very successful Christmas Fair and many people enjoyed the concert given by the Mountain Harmony Choir in December. There were good congregations over Christmas, especially at the service of Nine Lessons and Carols and the Midnight Communion.

There is always a friendly crowd of people who attend services and the frequent social events. One regular event that we would like to draw to people's attention is the monthly coffee morning, 10.30am to 12.00am on the second Saturday of each month, held in church and simply offered as a service to the community - a chance to meet other people from the village, relax, chat and enjoy tea, coffee and refreshments.

We are always looking for the church to grow, especially at our regular services on Sundays, the monthly Service for Families, Praise and Play, Messy Church etc. Please ring for more details, or come along to see what we do. You are guaranteed a warm welcome.

We are also looking to grow in support in other ways, including a list of 'Friends of All Saints' who are willing to offer occasional help by giving time, professional, skilled or labouring services, donating goods for sales, or helping at our functions and fund-raising events. Please ring if you would like to be included.

Our present costs are £3,500 per month, raised entirely from the giving of the congregations and support from the wider community. This covers running costs and a vicar on two-thirds time. However, we are currently not able to meet all our bills and, after I go, this may have to reduce to a half-time vicar, which is less than the parish warrants or needs. People can help with

finances by

- buying the church magazine, delivered monthly for £5 a year
- joining the 100 Club; shares cost £2 per month, with a £50 monthly prize
- giving regularly (100 people giving £5 per month, particularly if gift-aided, would increase income enough to guarantee paying for a vicar two-thirds time)
- you might like to consider including a legacy to the church in your will.

If you would like more information or to offer help, please ring me, or one of the churchwardens, John Hallas 881317 and Brian Eyres 880416.

Rev Brian Harris
Tel: 880213



The Rotary Club of Saughall

Saughall Rotary continues to be a very active group breaking the mould in many respects with its fun, energy and fund raising events.

A variety night was held at the Mercure in Chester, where 120 people were entertained with song, wit and dance. The £3,000 raised will go to Broadgreen Heart and Lung Hospital in Liverpool.



Also, £1,000 was presented to The Hospice of the Good Shepherd and the Golden Link will be enjoying a meal as a Rotary

Christmas present.

The group were delighted to be in association with the Vernon Institute for the very successful Christmas Light switch on; Father Christmas on his sleigh followed by hundreds of children still evokes lovely memories.

The Rotary Sports Day has been confirmed as Saturday, 14 July 2012 in the Golden Jubilee Park with the famous Saughall Mile being a challenge for all. We hope for a great turnout.

Martin Neenan the current president welcomes views, ideas, suggestions and new members if they fit the criteria of wanting to give something back to the community.

Andrew Errington
Saughall Rotary

Saughall Women's Institute Forthcoming Events

Tuesday, 7 February

- The Shrigley Abduction

Tuesday, 6 March

- A Liverpool Registrar

Tuesday, 3 April

- Members' Night

Tuesday, 1 May

- Resolutions + Beautiful Hats

Meetings are held at 7:30pm in the Vernon Institute. New Members and visitors are always welcome.

Lesley Hardy
Email: colinhardyuk@btinternet.com

**The Big
Lunch –
Sunday, 3
June 2012**



Why not take part in the nationwide get-together for neighbours – a great excuse to get to know people, try new things and have a party!

The Big Lunch is a very simple idea from the Eden Project. The aim is to get as many people as possible across the whole of the UK to have lunch with their neighbours in a simple act of community, friendship and fun.

Last year on Sunday, 5 June the best part of two million people took part. In 2012 The Big Lunch falls on the same weekend as The Queen's Diamond Jubilee celebrations on Sunday, 3 June and as announced by Buckingham Palace **The Big Jubilee Lunch** will be a part of the main programme of events over the central weekend of the Diamond Jubilee. A record number of people are expected to take part. Why not be one of them?

A Big Lunch can be anything from a few neighbours getting together in the garden or on the street, to a full blown street party with food, music and decoration that quite literally stops the traffic.

Since starting in 2009, thousands of Big Lunches have taken place in all kinds of communities across the UK and the best part of a million people get involved each year.

Get started by visiting: www.thebiglunch.com to download your free pack today.

Why pay if you don't have to?

Warranties and Guarantees

When you buy goods, whether on their own (like a washing machine) or as part of a larger piece of work (such as a new bathroom installation), by law those goods must be of "satisfactory quality" and be "fit for their purpose". They must be of a standard that a person would expect, bearing in mind the price paid, and be free from minor defects, be as described, and last a reasonable length of time for a product of that type. So if, for instance, the normal life of a washing machine is five years and yours stops working after two years due to a defect, you may be able to claim for a repair or replacement from the business you bought it from. This is the case regardless of whether you bought a warranty or guarantee. So consider carefully whether a warranty gives you anything extra.

Claiming from your debit card or credit card

If you are in dispute with a trader, instead of taking them to court, find out whether your bank may be able to help you. If you paid for something on a **debit card** and there turns out to be problems with the purchase, many banks offer a 'charge back' scheme where they refund you. Furthermore, if you pay for something worth over £100 and pay for at least some of it on your **credit card**, the credit card company is equally as responsible as the business that breaks its contract with you. So, if your holiday isn't as it was described, if your new dining table arrives damaged, or if your new TV breaks down soon after purchase, you can insist that your credit card provider helps you if the shop won't. This is even the case if you have paid off the amount you put on your credit card.

Personal Protection Insurance

We hear about companies offering to claim compensation for the mis-selling of personal protection insurance on residents' behalf, whether in relation to a loan, mortgage or

credit card. This is actually something you can do yourself. The Financial Ombudsman has produced a leaflet which is available on www.financialombudsman.org.uk on how to make the complaint yourself. If you don't have access to the internet, you can contact the Financial Ombudsman for advice over the telephone on 0800 0234567.

European Health Insurance cards

Even though some companies sell them, you can actually obtain a European Health Insurance Card (EHIC) free of charge which entitles you to medical treatment that becomes necessary, at a reduced cost or sometimes free, when visiting a country in the European Union, Norway, Switzerland, Iceland and Liechtenstein. This is limited to treatment provided under the state scheme and you will need to produce your EHIC card. Visit www.ehic.org.uk to find out more and apply.

Legal advice

There are many sources of free legal advice available to residents. To report a matter to Cheshire Trading Standards or to seek advice please contact [Consumer Direct North West](http://www.consumerdirectnorthwest.co.uk).



Staff at Consumer Direct will advise you and will also refer complex enquiries, urgent enquiries and those requiring further action to Cheshire Trading Standards Telephone: 08454 04 05 06.

The Citizens Advice Bureaux offer advice on a wide range of issues including debt, benefits, employment, housing and family issues. Visit www.citizensadvice.org.uk or call 08444 111 444. Also, many people can get free legal advice under their home insurance policies; check yours to see if you can get assistance.

Activities at the Vernon Institute

A variety of activities take place at the Vernon Institute. Please see the notice board in the entrance hall for exact times and contact numbers. Activities include:

- Pilates
- Badminton
- Table Tennis
- Snooker/Billiards
- Women's Institute
- Saughall Library in the small hall.
Open:
Tuesday 3 - 4pm
- Art Club on Tuesdays, limited numbers, telephone 880733
- Knit and Natter on Tuesdays, 2:30 – 4pm in the small hall
- Gardening Club
- Golden Link
- Play School
- Whist
- Art Club
- Dancing Schools
- Slimming World
- Farmers' Market – All local produce, Every Saturday 9am – 12pm in the Small Hall.

Activities at All Saints Church

- Senior Monday Meeting
- Children's Group Meetings and Activities
- Praise and Play

Activities at the Methodist Church

The following activities are provided in the Methodist Hall. The Bookings Secretary is June Downes who can let you have further details (Tel: 880181).

- Mother and Toddlers Group
- Friday Club
- Mollington Singers Choir
- Chester Dance Academy
- The Art Class with John Paskin
- Coffee Morning, once a fortnight

The Beauty Lodge

Jane Furnival wishes everyone a Happy New Year.

NEW YEAR!! NEW YOU!!

- To relax after the stresses and late nights over Christmas..... a 1/2 HR-MASSAGE is still £20
- Refresh the feet.... choose a PEDICURE now £20
- Regrow your nails.....enjoy a MANICURE for £15
- WAXING PACKAGES start at £25
- EYEBROW SHAPING only £5

The website provides a full pricelist www.thebeautylodge.com/saughall

Be professionally pampered at the beautiful little BEAUTY LODGE
Tel: 881111

Ladies Choir

The Ladies choir meets every Monday at 7:30pm in the Methodist Church Hall. New members are welcome.

Please contact Diane Barker on Tel: 880224.



Newsletter by email

If you would like to be added to the list to receive the Newsletter electronically please contact the clerk.

Email: clerk@saughall.gov.uk

It is appreciated that many people do not have access to email so delivery with the Standard Newspaper will continue as before for most villagers.



Mini Strictly Dance Class - from age 4 years

Saturdays - Vernon Institute - 9am - Term Time

Lots of fun, helps build confidence and deportment

No Join up fees

Dance Exams 2011

50 Students, Adults and children took Allied Dance Association Exams at the end of the summer term and we were privileged to host David Hipshaw the World President of the Allied Dance Assoc. as our examiner. Students all achieved excellent grades and comments. Dawn was awarded Dance Matrix Teacher 2011 from 1000 dance matrix teachers across the UK & NI.

Ladies Latino Dance Class - No Partners Required - Enters it's 5th Year

If you like to dance but don't have a dance partner - then this class is for you

Pre Book places on 01244 881092 or 07905571515

Vernon Institute - Monday & Thursday Evenings

For more information call or email bruceschoolofdance@hotmail.co.uk

WHO'S WHO on the Council

Parish Councillors

<p>Kathy Ford 6 Vernon Close Saughall Chester CH1 6BH 01244 881459 katherine.ford1@btinternet.com</p>	<p>Dennis Holman 28 The Ridings Saughall Chester CH1 6AX 01244 881593 d.holman@chester.ac.uk</p>	<p>Ian Humphrey (also Homewatch Co-ordinator) 1 Smithy Close Saughall Chester CH1 6ED 01244 880011</p>
<p>Jean Johnson Oaktree Nurseries Fiddlers Lane Saughall Chester CH1 6DH 01244 880895</p>	<p>Brian Kerr OBE 33 Greenway Saughall Chester CH1 6EG 01244 880347 briankerr@uwclub.net</p>	<p>Janette Knox 7 Rosewood Grove Saughall Chester CH1 6AN 01244 881259 janette.knox@calday.wirral.sch.uk</p>
<p>Rakesh Shukla 30 Church Road Saughall Chester CH1 6EP 01244 881765 rakesh@saughallpharmacy.co.uk</p>	<p>Andrew Storrar Hey House Farm Fiddlers Lane Saughall Chester CH1 6DH 01244 880226 andrewstorrar@hotmail.co.uk</p>	<p>Jeanne Storrar Hey House Farm Fiddlers Lane Saughall Chester CH1 6DH 01244 880226 jeannestorrar@hotmail.co.uk</p>
<p>Andrew Warrington 6 Worsley Avenue Saughall Chester CH1 6BG 01244 880418 andrewwarrington@hotmail.co.uk</p>	<p>Dolores Whitton JP 2 Darlington Crescent Saughall Chester CH1 6DB 01244 881411 dandpcwhitton@talktalk.net</p>	<p>Jenny Young – Chairman 212 Hermitage Road Saughall Chester CH1 6AE 01244 881133 chairman@saughall.gov.uk</p>
<p>Peter Young 62 Hermitage Road Saughall Chester CH1 6AQ 01244 880685 Pete4848young@yahoo.co.uk</p>	<p>Clerk to the Council Shirley Hudspeth 10 Merton Close Little Neston Cheshire CH64 0TR 0151 336 3367 clerk@saughall.gov.uk</p>	<p>Cheshire West and Chester Councillor Brian Crowe Glebe Farm Coalpit Lane Mollington Chester CH1 6JL 01244 851384 brian.crowe@cheshirewestandchester.gov.uk</p>
Member of Parliament	Local Police	Homewatch
<p>Stephen Mosley MP Unionist Buildings Nicholas Street Chester. CH1 2NX Tel 01244 458120 Email: Stephen@chestermpp.com Website: www.chestermpp.com</p>	<p>Blacon Police Station, Blacon Avenue, Chester, CH1 5BD 01244 350222 (The number to ring when reporting a crime) Saughall's PCSO is Wendy Leason Wendy.leason@cheshire.pnn.police.Uk Voicemail 0845 458 6375 to leave a message 0845 4580000 (switchboard)</p>	<p>Ian Humphrey (Chairman) 1 Smithy Close Saughall Chester CH1 6ED 01244 880011</p>

If you would like to advertise your business in our next newsletter or you represent a local non profit making group in the parish and would like to promote your group, please contact the Clerk.

SUPPORTING OUR LOCAL BUSINESSES

'USE THEM OR LOSE THEM!'

CO-OPERATIVE STORE

Church Road, Saughall.
'Everything you need from your local
friendly village shop'
Tel. No. 881408

SAUGHALL SERVICE STATION

Church Road, Saughall
'For all your motoring needs'
Tel. No. 881625

CHESTNUT HOUSE DAY NURSERY

Church Road, Saughall
'Quality care for Children'
Tel. No. 880371

BARRA BOARDING KENNELS

Parkgate Road, Saughall
Tel. No. 880837

LITTLE CREEK DOG KENNELS

Kingswood Lane, Saughall
Tel. No. 880267

FAR EAST

CHINESE TAKE-AWAY
Fiddlers Lane, Saughall
Tel. No. 881621

BELL STONE MASONRY

8 Eastfields, Saughall
Tel. No. 657925
www.bsmasonry.co.uk
email:
leebellstonemasonry@hotmail.co.uk

SAUGHALL POST OFFICE

Within the Co-operative Stores,
Tel No. 880403

P DAVIES

Qualified Tradesman

- Painting & Decorating
- Property Maintenance
(Private & Domestic)

Tel. No. 880564
Mobile No. 07708330058

OAK TREE NURSERIES

Fiddlers Lane, Saughall
'Come along and see us – you won't be
disappointed'
Tel. No. 880895

CREATIVE PHOTOGRAPHY

'Wedding and Social'
Maurice Alley, Church Road, Saughall
Tel. No. 880606

W. GATER, PLUMBER

'Plumbing and Heating Engineers'
Tel. No. 880654

DR. WILLIAM RICHARDSON

Homeopathy
Church Road, Saughall
Tel. No. 880574

CHESTER SECURITY SYSTEMS

32, Church Road, Saughall
'Our business is your peace of mind'
Tel. No. 881399
Email info@chestersecurity.co.uk

SUPERIOR DRY CLEANERS

In your area every week providing the
following:

- Dry Cleaning Service
 - Ironing Service
 - Alterations and new zips
 - Carpet, rug and upholstery cleaning
- Tel. Rob Parry on 07788 157431

NEIL RICHARDS – ELECTRICAL CONTRACTOR

All types of electrical work undertaken
Tel. No. 881732
Email: nsrichards@yahoo.co.uk
Mobile No. 07981051992

SAUGHALL ROOF CARE

9 Saughall Hey
All roof work carried out
Tel. No. 880756
Mobile No. 07871966000

CHESTER PAINT STRIPPERS

Reclaimed doors & fire places for sale
Sea Hill Farm, Saughall
Tel. No. 881771

READES RESIDENTIAL

'Lettings and Property Management'
www.readesresidential.com
Tel. No. 08450 097 097

SAUGHALL VILLAGE SURGERY

Church Road, Saughall
Tel. No. 881590

WHEATSHEAF INN

Parkgate Road, Saughall
Tel. No. 851804

EGERTON ARMS INN

Hermitage Road, Saughall
Tel. No. 881369

GREYHOUND INN

Seahill Road, Saughall
Tel. No. 881122
www.thegreyhoundinnsaughall.co.uk

JS MORTGAGES

11 Hermitage Road, Saughall
Tel. No. 881848
Email: jaqirsingh@btinternet.com

SAUGHALL PHARMACY

30 Church Road, Saughall
'Your very own friendly dispensing
chemist'
Tel. No. 881765

GOBLIN GARDENING

43 Rakeway, Saughall
Tel. No. 657967
Email: goblingarden@btinternet.com

PH LEWIS – JOINER

All types of work undertaken – Windows,
doors, floors, etc
Tel. No. 0789 424 0289

CELIA'S FLOWERS (LOCAL FLORIST)

Weddings, Funerals, Gift Bouquets etc.
City & Guilds Floristry
Tel. No. 01244 377160
Email: cgifford14@tiscali.co.uk

DJ GARDENING SERVICES

Grass Cutting/Hedge Cutting
Tree Surgery/Pruning
Gravel Work/Paving/Turfing
Driveway/Cleaning
OAP Discount Rates
Domestic/Commercial
Fully Insured
Free Estimates
Tel. No 01244 880802
07800944754
Email: daveyedwards71@hotmail.co.uk

BESPOKE BRIDES

Designer wedding gowns and
bridesmaid dresses to suit all budgets.
Coalpit lane, Saughall, Chester
www.bespokebrides.co.uk
Tel. No. 0800 619 9348

B. J. CLEGG & SON

'Plumbing, heating and gas fittings'
Tel. No. 880120

YVONNE MCSHERRY REIKE MASTER TEACHER ICHT IIHHT MASC BSY(MED- TEACH)

Email: VonnieMcS@aol.com
Tel: 01244 881691
Mob: 07986 21 2128
Web: www.reikipower.co.uk

PA PROPERTY SERVICES

Extensions, Garage Conversions,
Kitchen and Bathroom Installations,
Plastering, Painting and Decorating.
Free No Obligation Quotations
Call Phil on: Tel 01244 881684
Mob 07731803464

Explore Learning

Explore Learning is a network of Ofsted registered tuition centres for 5-14 year olds, where inspiring tutors work with children on Maths and English courses that are created to meet and adjust to the individual needs of every child. As our courses are also mapped to the National Curriculum, Explore Learning complements and supports your child's work at school.

Explore Learning caters for children of all abilities, as our individualised learning programmes allow our members to work at a level and pace best suited to their needs; stretching and challenging them where appropriate. Our excellent tutors make our centre a fun and friendly place where children boost their confidence, make academic progress, and enjoy learning!

We offer all families a FREE INITIAL CONSULTATION at our education centre located inside Sainsbury's, Great Boughton. During this session, one of our inspiring tutors will work with your child and demonstrate how exciting maths and English can be. They will then take the time to discuss your child's individual needs with you and explain how Explore Learning can unlock their potential.

To book your free trial session, or for more information, please call us on 01244 343433 or visit our website at www.explorelearning.co.uk/chester.

CLEAN AND DRY CLEANING SERVICES

Carpets, rugs, scotch guarding and upholstery spring clean deeps, one off cleans, supplies cheap bulk cleaning products
Call: Wyn on Mob 07590698085

A & G PLASTERING

Quality work guaranteed. For a free no obligation quote phone Gordon on:
Tel. No. 880765 or Mobile: 0791 773 4376

FIX & REPAIR

We don't seem to repair things anymore.
For example:
wood rot or wear e.g. doors, staircases conservatories where the upper construction is good
metric replacements that won't fit e.g. locks, door & furniture machines, stoves and Agas where there are no new part
Fix and Repair considers a cost effective solution to these types of problem:
hidden brackets to repair stairs & banisters
new wood inserted, part replacement with brickwork
original fittings can be repaired
heavy stoves and machinery repaired in situ

Fix and Repair can also fix:-
• new shelves • doors • locks • plumbing (e.g. a downstairs WC) • kitchens • brick fireplaces • wood-burning stoves • flat pack furniture assembled/modified (e.g. extra doors/shelves can be fitted).

In these times of economic austerity can you afford not to consider a repair first?

Copperfield, Church Road, Saughall.
Call Howard on Mobile: 07949 377943

SJR HEALTH AND FITNESS

Based in Saughall
Ladies Bootcamps
Personal Training on a one to one basis
Sue Richards
Tel: 07789072109
email: sjrfitness@yahoo.co.uk

RON STUART AERIALS

'All types supplied and installed'
Tel. No. 880352

<p>CARAVAN CLUB CERTIFICATED LOCATION 5 VANS ELECTRIC POINTS AVAILABLE OPEN ALL YEAR ROUND</p> <p>Mill Cottage North, Parkgate Road Tel: 01244 881284 Mob: 07715553743</p>	<p>UTILITY WAREHOUSE DISCOUNT CLUB</p> <p>Would you like to save money on all your household bills? Join the Club!</p> <p>Single bill for all your utilities Award-winning customer service Value that's unbeatable Easy to switch</p> <p>Save 5% on all your petrol and household shopping too!</p> <p>Ask How! Get in Touch! Call Rachel on 881181 or 07877 670625 www.telecomplus.org.uk/rachellowe</p>	<p>THE PRIVATE TUTOR</p> <p>Preparation for 11+ Grammar School selection tests, Independent School entrance tests, KS2 SATs English, Mathematics. Over 15 years experience co-author of The Tutors product range Tel:01244 851638 website: www.theprivatetutor.co.uk Location: Astbury Villa South, Saughall Contact: Janet Peace</p>
---	--	---

There is still empty space available! If you would like your local business advertised in the next newsletter, please contact the Clerk.

USEFUL CONTACT NUMBERS

Women's Institute
Mrs Mary Evans,
Tel: 880177

Saughall Gardening Club
Gill Whittaker
Tel: 881059

All Saints Church
Vicar: Rev Brian Harris
Tel: 880213

Saughall Cricket Club
Mr Brian Huxley, Tel: 880753

Saughall Colts Junior Football Club

Email:
brian@jbharris.fsnet.co.uk

Saughall Table Tennis Club
Mr Bob Salisbury, Tel: 881323
email:
rm.salisbury@btopenworld.com

Football for children aged 6-16

Mr Steve Richards 881896
www.saughallcolts.co.uk

Church Wardens
John Hallas Tel: 881317
Brian Eyres Tel: 880416

Saughall Community Day Centre
Church Road, Saughall
Tel: 880474

Golden Link Club
Margaret Grain,
Tel: 881294

Pre-School Group
Mrs Lynda Johnson, Tel:
880954 (Term time only)

Uniform Groups and Scout Hut
Bookings
Phil Brooks
Tel: 881284

All Saints Primary School
Headteacher – Donna
Prenton
Tel: 981090

Saughall Neighbourhood Management Team
Co-ordinator
Tony Summers
0770 762 2062

VI Badminton
Chris Harman Tel: 880205
email: chrisjharman@aol.com